

PAC INTERNATIONAL, INC.

RSIC-JOIST ISOLATOR SOUND ISOLATION CLIP



RSIC-Joist Isolator

The **RSIC-Joist Isolator** is designed to support framing members and float the framing member from the surrounding structure. A raised floor isolated with the RSIC-Joist Isolators improves low frequency definition. The RSIC-Joist isolator has 1/8" deflection with a 1000 lb load.

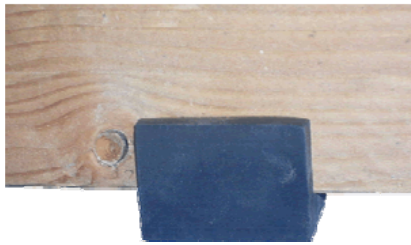

Spacing is max 16" x 72" or 24" x 48" oc.

RSIC, the Low Cost, High Performance, Noise control Solution



Wood
Steel
Metal deck
Concrete

Apartment
Condo
Commercial
Retail

Recording Studio
Home Theater
Commercial theater
Conference Rooms

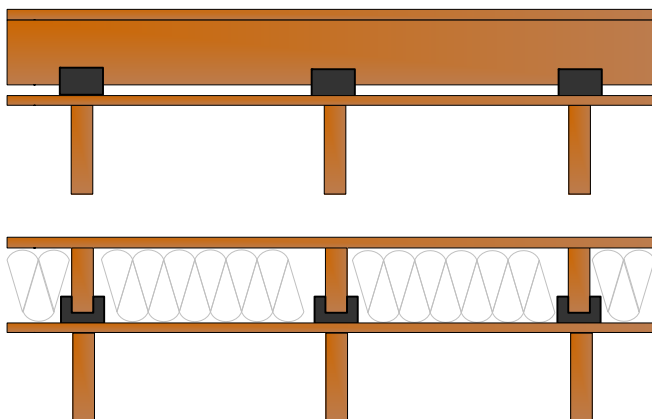
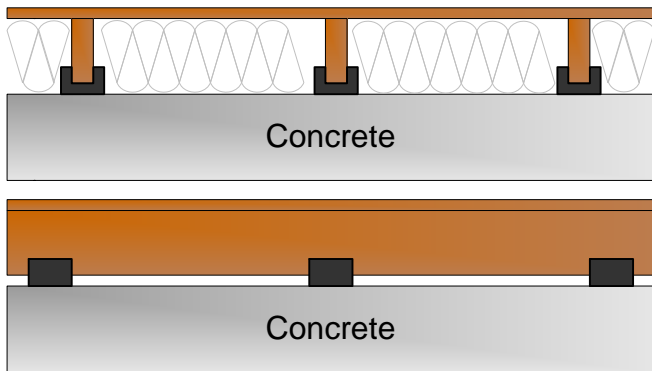

RSIC-Joist Isolator specifications:

Acoustical design load:	1000
Total deflection	3 mm
Double deflection	N/A
Low VOC treated	Yes
Adjustable	No
Cavity min	3.5"
Cavity Max	No limit
Adjustment limit	Joist size min. 2x4
Use on Floors	Yes
Use on walls	No
New Construction	Yes
Retro Fit	Yes

PAC INTERNATIONAL, INC.

RSIC-JOIST ISOLATOR SOUND ISOLATION CLIP

Spacing 24" x 48" oc. Max. Positioned parallel or perpendicular over joist.

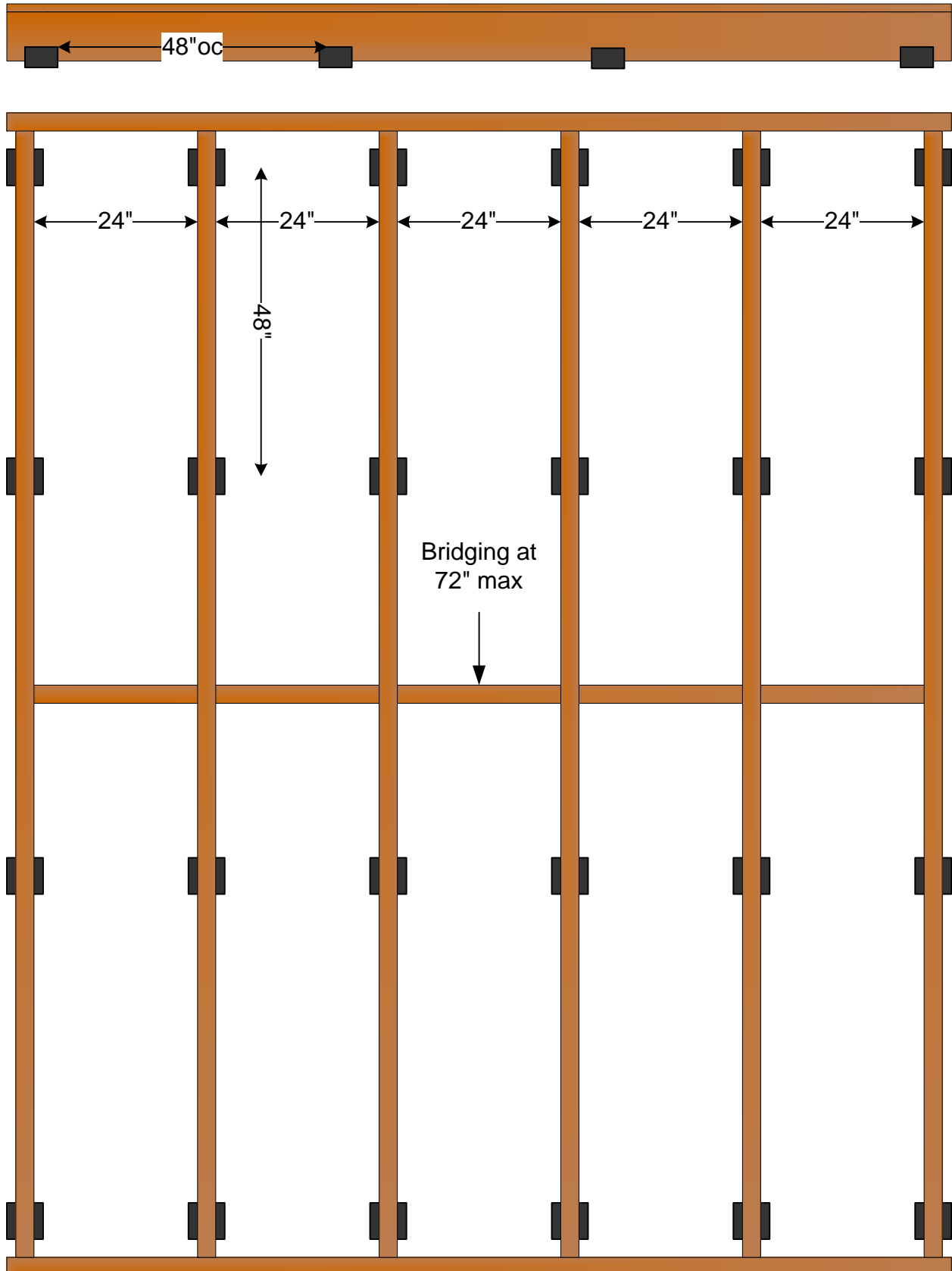

PAC INTERNATIONAL, INC.

RSIC-JOIST ISOLATOR SOUND ISOLATION CLIP

Spacing 16" x 72" oc. Max. Positioned parallel or perpendicular over joist.

